

Courses & Distances
Beginning at Post at
head of the Island

Station	Courses	Dist. in perches
1	S. 27 1/2° W	3.7
2 ^d	S. 8 1/2° E	4.4
3 ^d	S. 43° W	6.3
4.	S. 37° E	4.5
5	S 64° W	12.7
6	S 10° W	8
7	S 86 3/4° W	7.5
8	N. 40 1/2° W	2.8
9.	N. 39 1/2° E	4.
10	N. 74° E	2
11	N 26 3/4° E	24
12	N. 62 1/2° E	2
13	N. 84° E	6.5

aboliterated

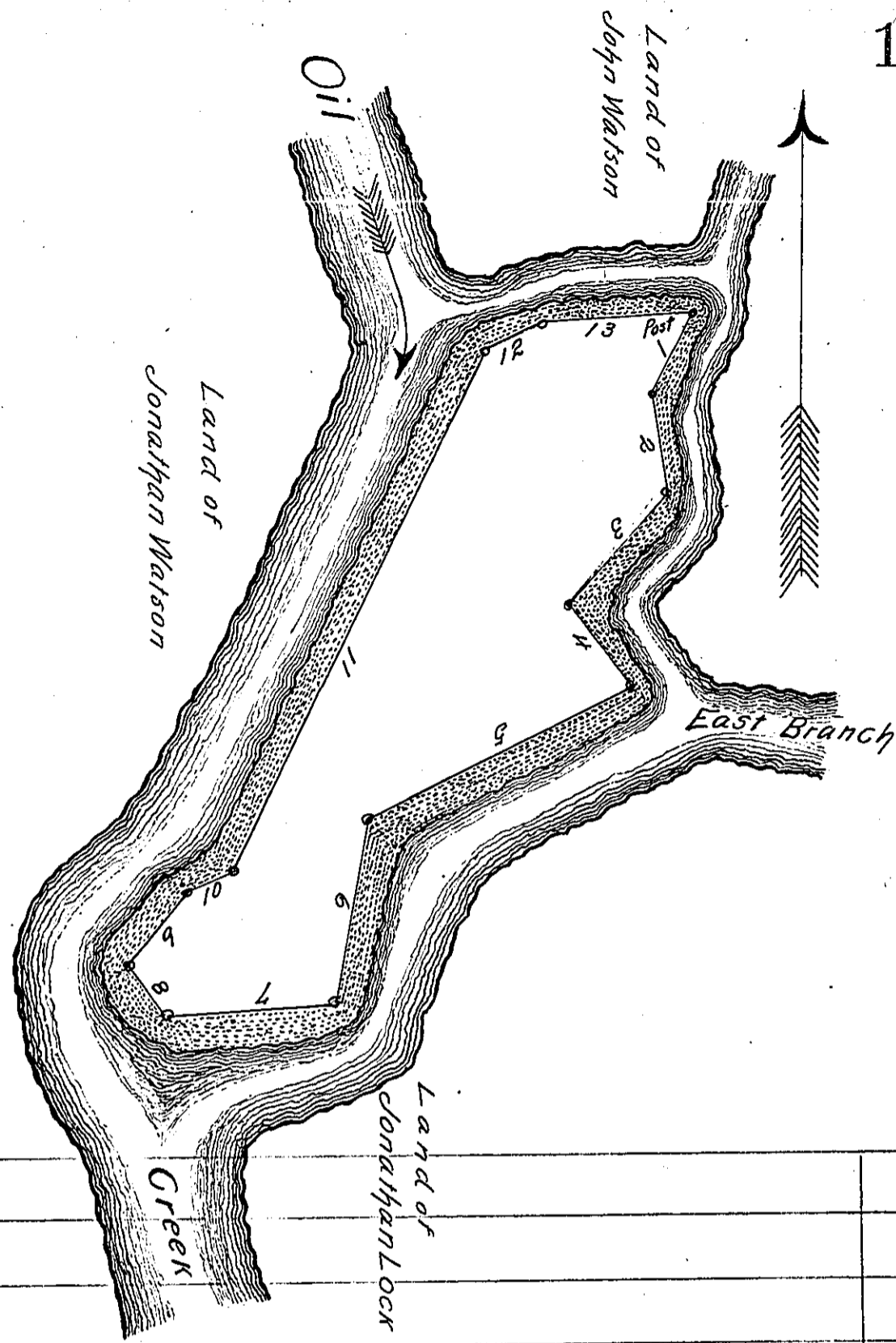

By Virtue of a Warrant, ^{dated} the 31st day of January ²⁰ one thousand eight hundred and Sixty one. Surveyed the 20th day of February 1861 To Jeremiah S. Campbell The above described Island in Oil Creek in the County of Crawford containing One acre and 96 Perches (heat Measure)

James Tryon Co. S.R.

To Hon. W^m H. Keim
Surveyor General

IN TESTIMONY that the above is a copy of the original remaining on file in the Department of Internal Affairs of Pennsylvania, made conformably to an Act of Assembly approved the 16th day of February, 1833, I have hereunto set my Hand and caused the Seal of said Department to be affixed at Harrisburg, this sixth day of June 1904

Joac R. Pearson
Secretary of Internal Affairs.